

Stud Link Anchor Chain

Stud Link Anchor Chain is commonly used for anchor and mooring chains. Stud Link Chain is commonly available in Grade U2 & U3 and can also be supplied as Grade 4 upon request.

Stud Link Anchor Chain has a central stud to add weight and prevent elongation under extreme loads. Stud-link chain is commonly supplied in 27.5mtr lengths & can be supplied in a hot dip galvanised or black finish. Generally supplied with LR Certification.

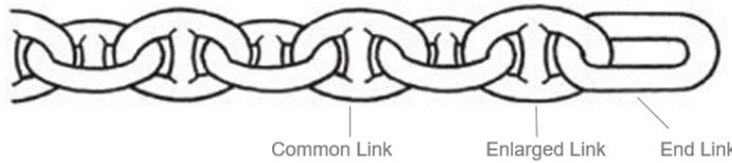
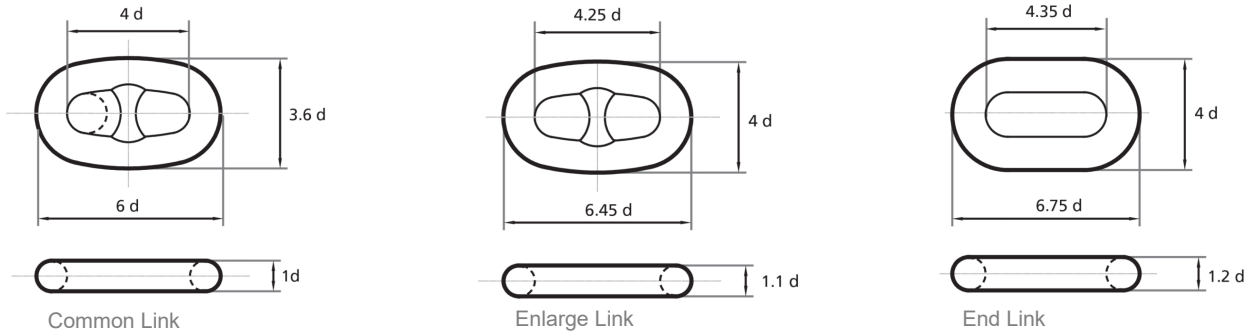

All dimensions are approximate
d = Diameter

(D) Diameter (mm)	GRADE U2		GRADE U3		OEL+EL+CL+++CL
	Proof Load (Tonne-F)	Break Load (Tonne-F)	Proof Load (Tonne-F)	Break Load (Tonne-F)	Weight kg/27.5m
12.5	6.7	9.4	9.4	13.5	110
14	8.4	11.8	11.8	16.8	130
16	10.9	15.3	15.3	22.0	158
17.5	13.0	18.3	18.3	26.1	194
19	15.3	21.5	21.5	30.7	236
20.5	17.8	24.9	24.9	35.6	270
22	20.4	28.6	28.6	40.9	323
24	24.2	33.9	33.9	48.5	371
26	28.3	39.7	39.7	56.7	432
28	32.7	45.8	45.8	65.5	498
30	37.5	52.4	52.4	74.9	566
32	42.5	59.4	59.4	84.9	638
34	47.7	66.8	66.8	95.5	715
36	53.3	74.6	74.6	107	804
38	59.3	82.8	82.8	118	892
40	65.3	91.4	91.4	131	1037
42	71.7	100	100	143	1090
44	78.4	110	110	157	1204
46	85.3	119	119	171	1318
48	92.6	130	130	185	1447
50	100	140	140	200	1557
52	108	151	151	215	1673
54	116	162	162	231	1805
56	124	174	174	248	1941
58	132	185	185	265	2103
60	141	198	198	282	2267
62	150	210	210	300	2382
64	159	223	223	319	2539

(D) Diameter (mm)	GRADE U2		GRADE U3		OEL+EL+CL+++CL
	Proof Load (Tonne-F)	Break Load (Tonne-F)	Proof Load (Tonne-F)	Break Load (Tonne-F)	Weight kg/27.5m
66	169	236	236	337	2701
68	178	250	250	357	2911
70	188	263	263	376	3040
73	203	283	283	407	3308
76	219	307	307	438	3586
78	230	322	322	459	3778
81	246	345	345	492	4075
84	263	368	368	526	4386
87	280	393	393	561	4709
90	298	417	417	596	5039
92	310	434	434	620	5265
95	329	460	460	657	5618
97	341	477	477	682	5857
100	360	504	504	720	6228
102	373	522	522	746	6491
105	393	550	550	785	6875
107	406	568	568	812	7138
111	433	606	606	865	7687
114	453	635	635	907	8109
117	474	664	664	948	8543
120	495	694	694	991	9015
122	510	714	714	1019	9297

Additional sizes available upon request